

# Series Ty Motor: Emitter Guide

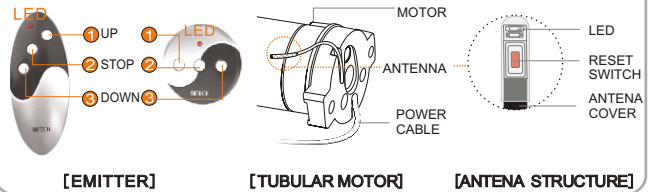

## [Diagrams]

Diagrams here for reference only.



## [STEP 1: Set up Emitter]

- 1 ➔ Connect motor to power
- 2 ➔ Press **Reset Switch** for 3 seconds
- 3 ➔ Press the **Stop Button** of the Emitter

Connect motor to power, press **Reset Switch** on the Antennae for around 3 seconds, then during the lighting of the LED, press **Stop Button** on the Emitter till the LED of antenna flashes, when Setup is accomplished, and the Emitter can work motor up and down.

## [STEP 2: Motor Limit End Positions Setup]

- 1 ➔ Connect motor to power
- 2 ➔ Press **2 + 3** Button together for 3 seconds

Connect to power, press **2 + 3** buttons for 3 seconds, LED of antenna will flash.

- 3 ➔ Down (Fabric OUT) Position Setup

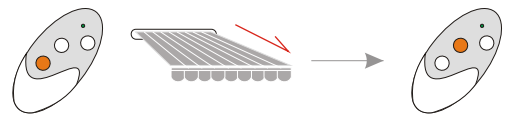

- 4 ➔ Up (Fabric IN) Position Setup

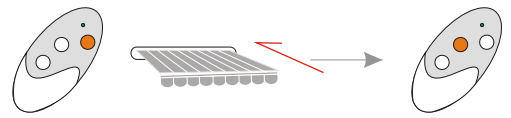

Press **3** button, then press **2** button when the awning arrives at correct **Downward** position; Press **1** button, then press **2** button when the awning arrives at where has 5cm distance to correct **Upward** position.

- 5 ➔ Setup for **Function of Contraction**

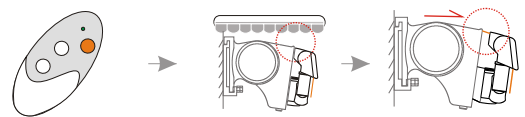

After operation #4, Press **1** button again for 1 second, awning fabric will be closed further tightly, and when the motor will stop automatically. (**WARNING: The Direction to setup Function of Contraction should be in the same as the direction to withdraw awning fabric.**)

## [Clear Emitter—only for use when Emitter lost, damaged or similar cases occur.]

- 1 ➔ Connect motor to power
- 2 ➔ Press reset button for 5 seconds

Connect to power, press **Reset Switch** for 5 seconds till the LED is off, when Emitter is cleared from motor's memory. To Setup a new Emitter, please refer to **STEP 1: Set up Emitter**. Limit End Positions Setup is NOT necessary for this new Emitter.