

## Installation procedure for Wind sensor:

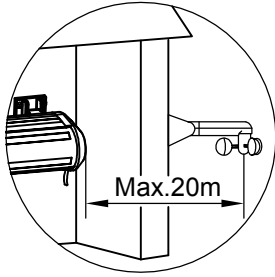

### Attention:

In order to ensure the wind sensor can react better to the weather change, the wind sensor should be installed outside and make it in a good ventilation.

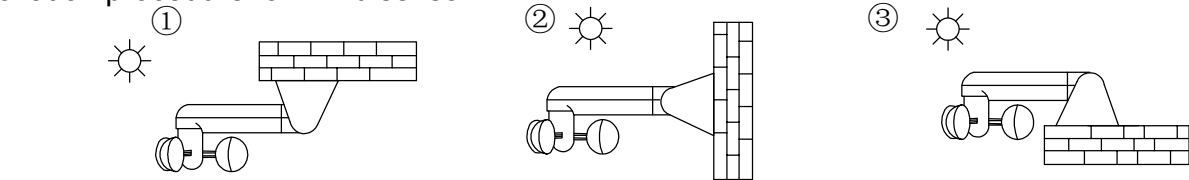
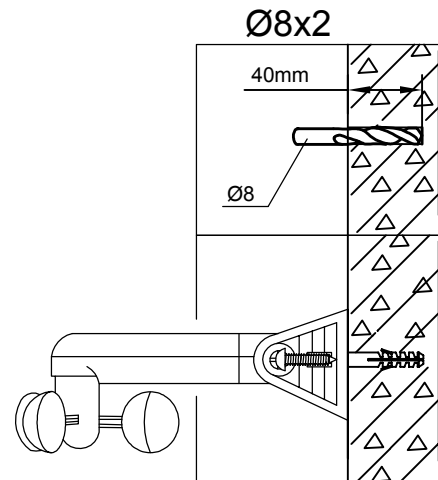
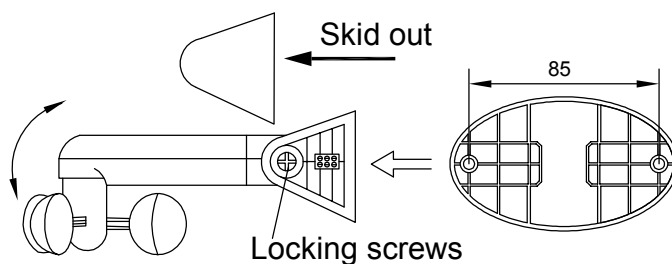

## Angle adjustment method for the wind sensor:

1. Skid out the fixing cap;
2. Unloosen the locking screws;
3. Turn the sensor to the proper direction;
4. Tighten the locking screws.

## Connection



**CAUTION, risk of electric shock.** The power connection of the awning shall be performed by a qualified technician only. To be installed under effective regulation.

- Make sure that the power supply corresponds to the appliance's specifications ( *Technical data* ). Interrupt power supply. Connect the cables in the terminal as follows.

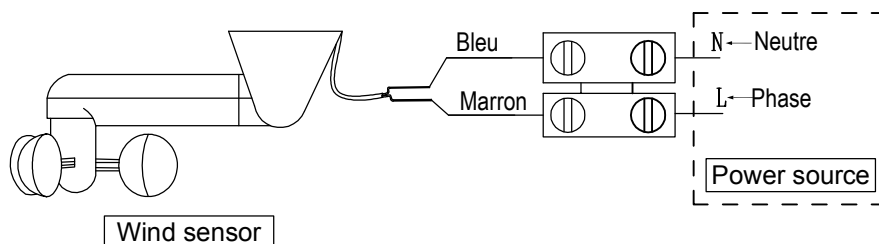

After finished all the conection of the wires according to the picture, pls remember to use the insulating tape to pack the wire individually.

风控器与遥控器对码。

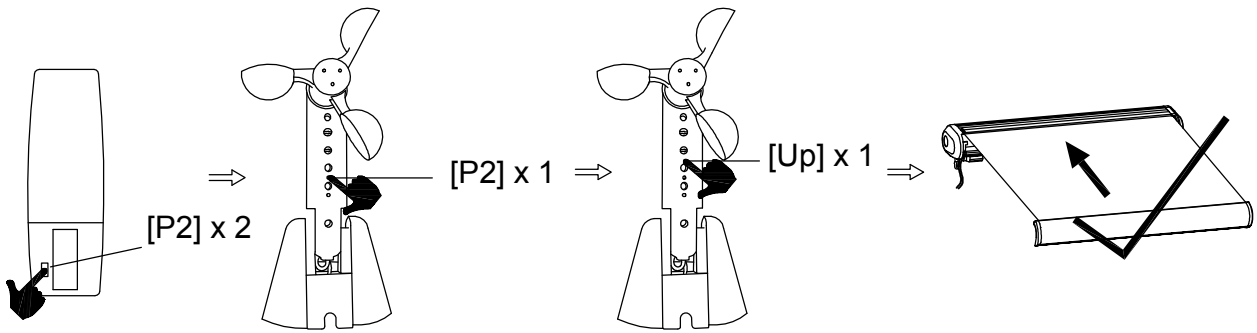

测试对码是否成功。

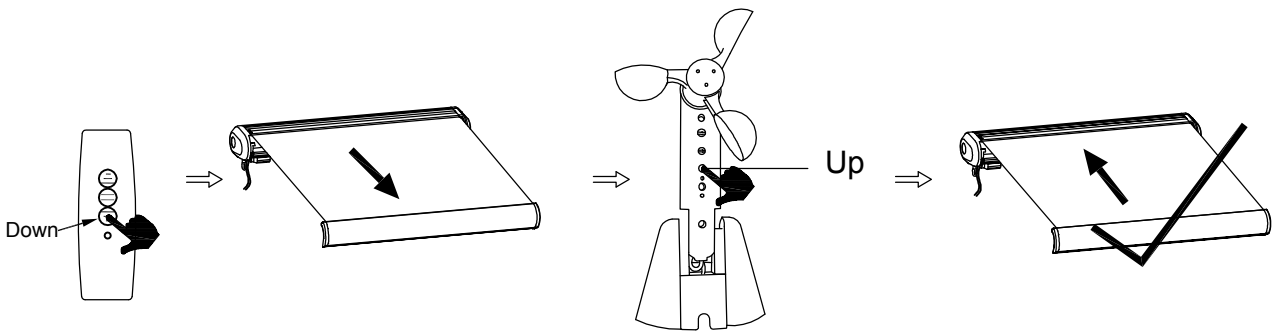

如果上面的操作没有将篷收拢，请重新做对码操作。

## Wind sensor grade adjusting reference

### Attention:

1. Sensor should be installed in a proper position, in order to make the sensor can react to the wind. Otherwise, the working performances of sensor would be affected, or damaged.
2. Sensor is set to roll back the awning when wind reaches to the setting Wind Grade. Awning will not open automatically when the wind stops.
3. Indicator light will twinkle when sensor works.
4. Wind sensor has a 5 minutes lag to protect the sensor, that is : Sensor will not work within 5 mins when it starts.
5. When the Wind Grade sets to "0", the sensor function will not work, and it will not react to any factor.

Wind grade reference	
1 grade	15Km/h
2 grade	30Km/h

