

Installation/User Manual

Smart Plug EU-01

About the Manual

This manual contains important instructions for the HERF SMART PLUG EU-01 and must be read in its entirety before installing or commissioning the equipment. For safety, only qualified technician, who has received training or has demonstrated skills can install and maintain this EU-01 under the guide of this document.

Other Information

Product information is subject to change without notice. User manual will be updated frequently, please refer to ESTAR official website at <https://estarpower.com> /for the latest version.

Table of Contents

Table of Contents	2
1. Terminals Introduction	3
2. Introduction to product software functions	5
3. Technical parameters	8

1. Terminals Introduction

1.1 About Smart Plug



Product series: WiFi Smart plug

Type: Smart switch module

Voltage: 100-240VAC 50/60Hz

Max.Load: 16A/3520W

Use method: Plug and play

MCU: BK7132t

Certification: CE/ROHS

Standby power consumption: 0.5W/Hour

1.2 Communication mode

Adopt the 2.4G wireless scheme with the router communication.

Only supports 2.4 GHz WiFi network.

2. Introduction to product software functions

2.1 APP download and installation

1) Scan the following QR code by using the mobile QR code function to download and install the Smart Life APP(for end user) . You can also search for the Smart Life App in the Apple store or the Google play for download and installation.



2.2 Registration and login

Note: the mobile phone and the smart plug should be on the same 2.4G WiFi, and the Bluetooth should be turned on.

- 1) Open the Smart Life App and Register for your account and log in.
- 2) Make sure the smart plug is mounted on the socket, and the indicator light blinks blue rapidly (twice per seconds) ,if not,press and hold the power button on the smart plug for 6seconds until the indicator light blinks rapidly.
- 3) Tap the icon " + " on the top right comer of APP,choose your device type and enter into "Add Device" .

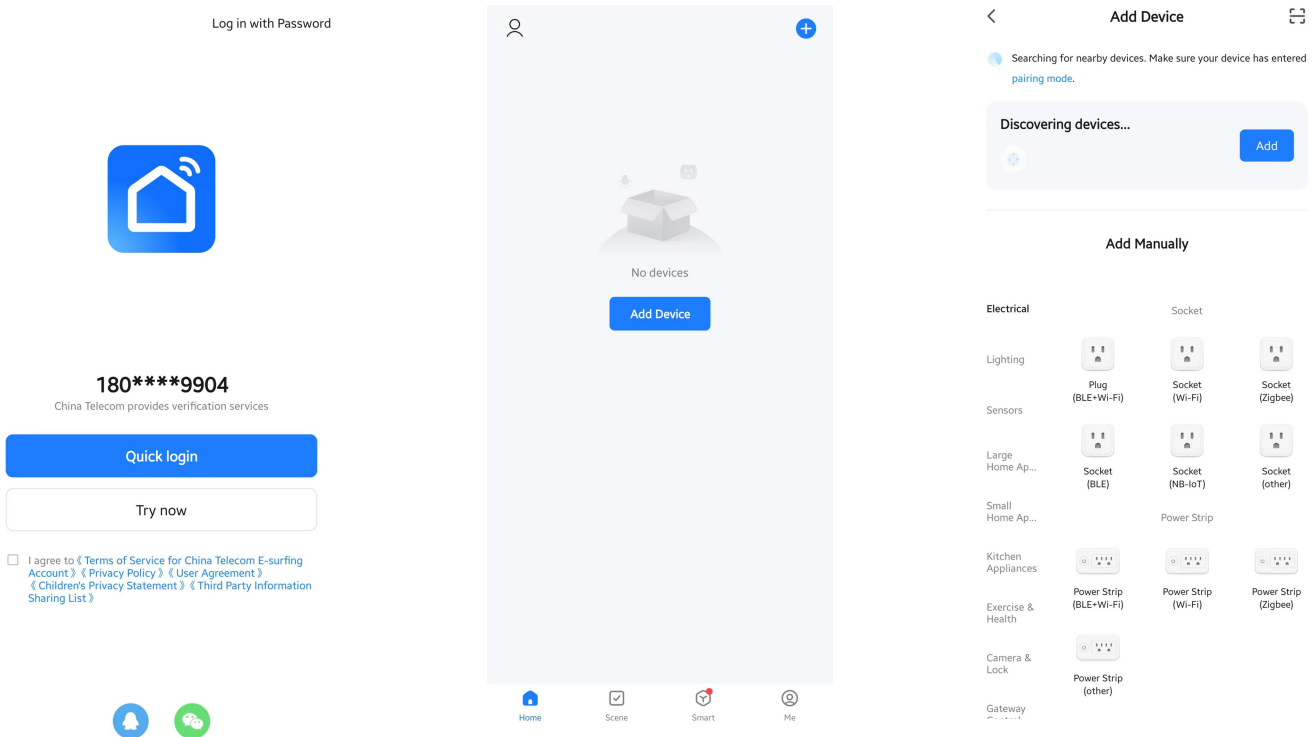

4) When the wifi connection page appears, please enter the wifi password of the current phone, and then click Next. Waiting for the distribution network to complete.

5) The interface is as follows

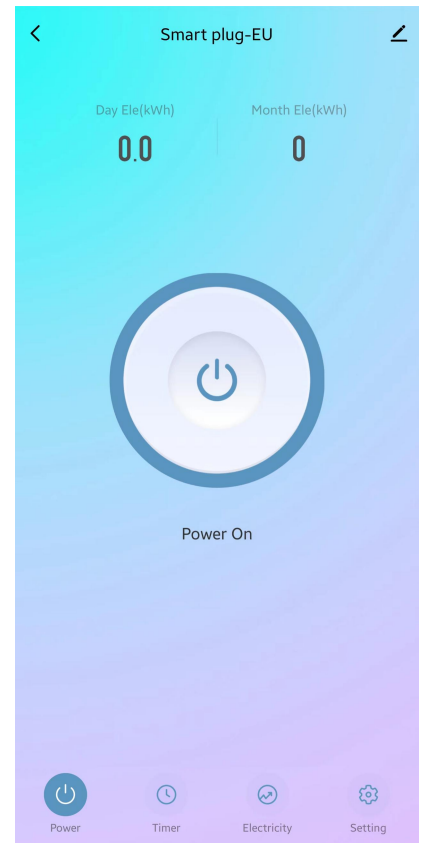
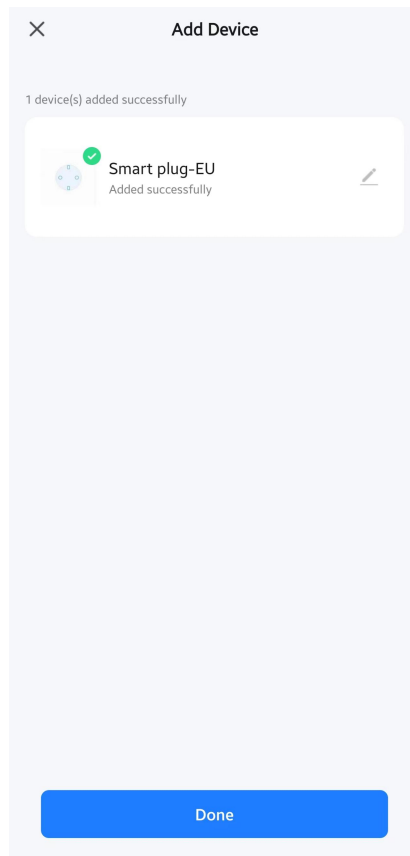
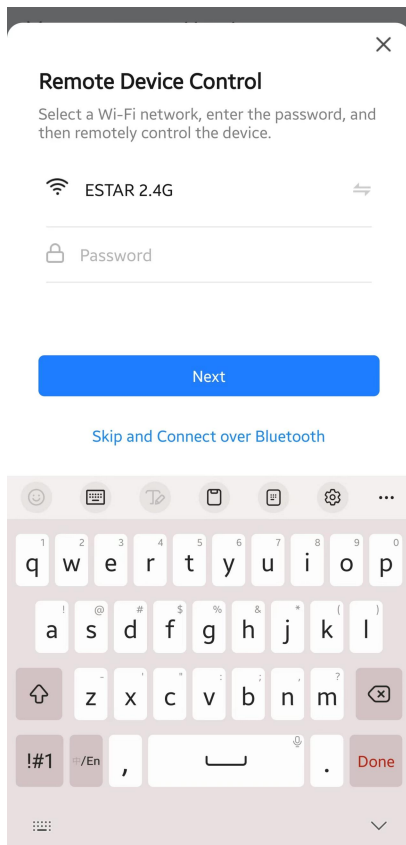

3. Technical parameters

Model	EU-01
Basic Information	
Product series	WiFi Smart plug
Type	Smart switch module
Voltage	100-240VAC 50/60Hz
Max.Load	16A/3520W
Use method	Plug and play
MCU	BK7132t
Certification	CE/ROHS
Standby power consumption	0.5W/Hour
Appearance	
Color	white
Dimension	50*50*80mm
Gross weight	93g
Casing material	PC+ABS
Features	
Functions	Remote control, smart timing/delay/countdown, status feedback, power-off memory, voice control, sharing function, smart scene control, manual switch, power statistics (can count: current, voltage, power, power consumption)

voice control	Alexa、 Google Assistant、 SmartThings、 DuSmart Speaker、 TmallGenie
Operating systems	Android & ios
Antenna	PCB board with antenna
Working Enviroment	
Applicable place	Indoor
Working temperature	-20°C - 50°C
Working humidity	5%-95% RH, non-condensing
Working height	Less than 2000m